

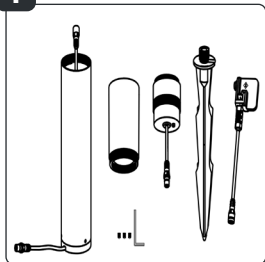

1



First, check if all parts are present.

2

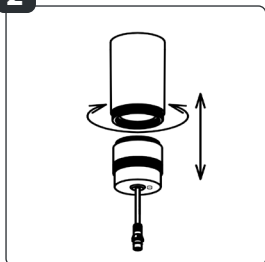

Tighten the lamp onto the bottom of the casing.

3

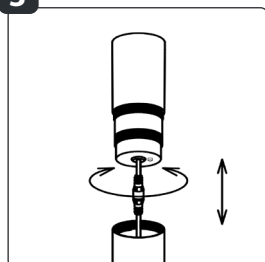

Connect the wiring of the housing to that of the lamp, then screw the housing onto the lamp.

4

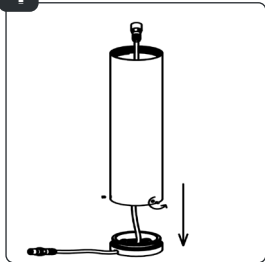

Option 1: Detach the bottom by unscrewing the 3 hex screws using the included hex key. Then, mount the bottom with the 3 provided screws at the desired position. Afterward, screw the top back onto the mounted bottom and secure it with the 3 hex screws.

Option 2: Screw the included spike onto the bottom of the lamp and insert the spike into the ground at the desired location.

5

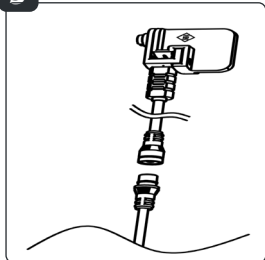

Connect the coupling piece of the standing light to the product cable connector.

6

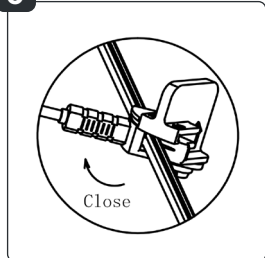

Attach the product connector to the 12-volt main cable and tighten the connector onto the main cable. Your lighting is now ready for use.